

Disassembly of a S16 for moving

GO SLOW – THINK AHEAD

Minimum Crew:

- Two normal healthy individuals, three if available

Tools:

- 5/16" Allen wrench
- 5/32" Allen wrench
- 9/16" combination wrench or deep wall socket (preferred)
- 7/8" combination wrench (supplied)
- Appliance dolly – the type with a strap
- ¼" nut driver
- Medium sized channel lock (aka water pump pliers) or adjustable wrench
- Padding of some sort: cardboard, rug scrap or old blanket

1. Remove tailstock and banjo.
2. Remove gap – loosen bolts under the gap with 7/8" wrench and lift the gap out. The long bolts are captive, but it is a good idea to take two of the flange nuts off of the studs and use them to keep the bolts up and out of the way.
3. OPTIONAL: Remove motor. The motor weighs about 35lbs. If you have good help, leave it on. If you want to get every ounce off the frame you can, then you will want to remove it
 - a. Loosen cord grip going into motor connection box using channel locks or adjustable wrench
 - b. Remove motor connection cover using nut driver
 - c. Remove black, red and white wires from wire nuts one at a time – noting location as each wire is removed. Replace wire nuts as you go on yellow motor lead wires. Leave any other wire nuts alone.

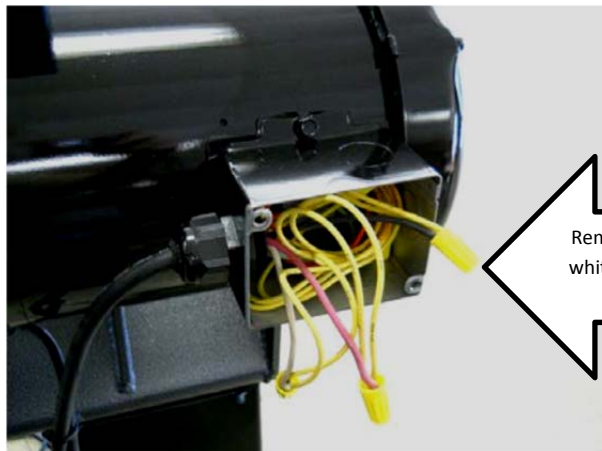

Remove wire nuts from black, red and white wires. Remove green wire using nut driver. Mark locations

- d. Disconnect green (ground) wire using nut driver.
- e. Remove cord from motor.

- f. Loosen belt – loosen two bolts indicated below and lift up on lever. Retighten bolts to keep the belt loose.

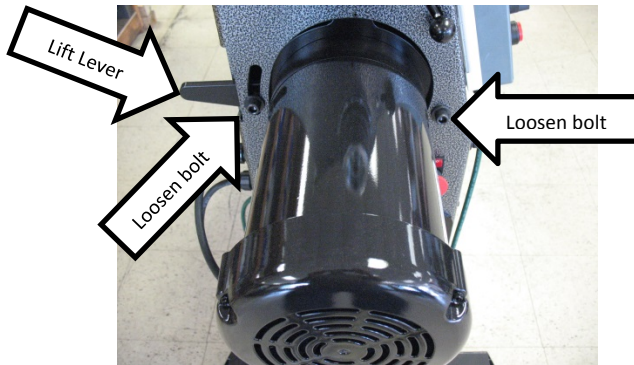

- g. Remove stainless steel guard from below spindle and remove four bolts holding motor.



- h. Remove motor

4. Place padding on floor and lay the lathe over on its side – front side is preferred, that way you aren't laying it on the wires coming out the back.
5. Remove the bolts holding in the legs with a 9/16 wrench and remove the legs
6. Put pads on the appliance dolly and put the frame on the dolly and take the frame to its new location.
7. Assembly is the reverse of the disassembly.

PLEASE NOTE: DO NOT, UNDER ANY CIRCUMSTANCES, REMOVE THE HEADSTOCK SECTION FROM THE BED SECTION – ALIGNMENT WILL BE LOST AND YOU WILL NEED TO SEND THE LATHE BACK TO ROBUST FOR REPAIR AND REALIGNMENT.

Questions, call Brent on his cell phone, 608-712-0717